

Estimated Time-frame: August 5th to October 25th, 2024

TEMP. CONSTRUCTION FENCE

PHASE 1

- Demolition of Sidewalk East and North
- Demolition of Sidewalk @ Crawspace Entrance
- Underfloor Work
- Installation of Storm Drain at East and North Sides

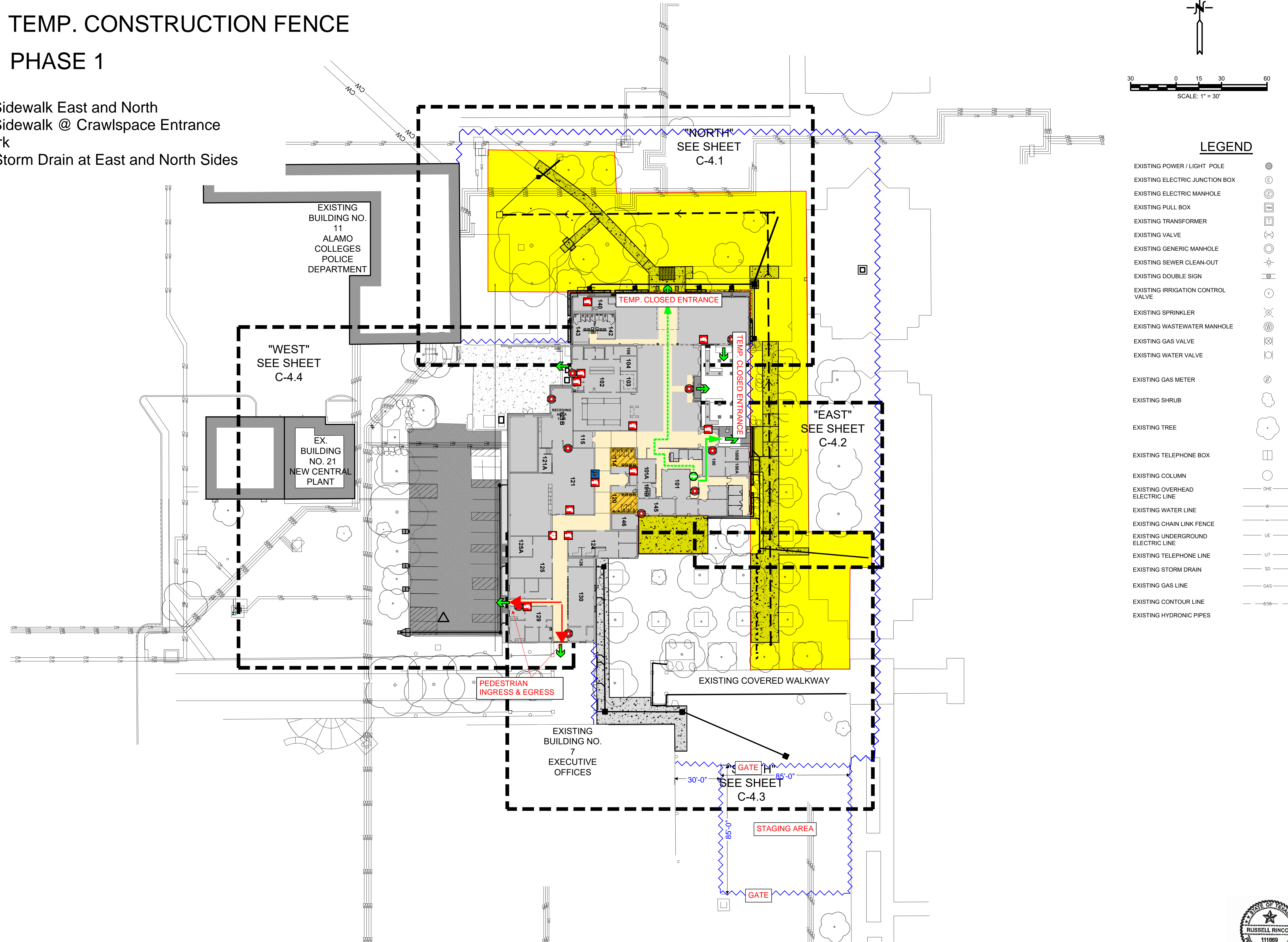

LEGEND

- EXISTING POWER / LIGHT POLE
- EXISTING ELECTRIC JUNCTION BOX
- EXISTING ELECTRIC MANHOLE
- EXISTING PULL BOX
- EXISTING TRANSFORMER
- EXISTING VALVE
- EXISTING GENERIC MANHOLE
- EXISTING SEWER CLEAN-OUT
- EXISTING DOUBLE SIGN
- EXISTING IRRIGATION CONTROL VALVE
- EXISTING SPRINKLER
- EXISTING WASTEWATER MANHOLE
- EXISTING GAS VALVE
- EXISTING WATER VALVE
- EXISTING GAS METER
- EXISTING SHRUB
- EXISTING TREE
- EXISTING TELEPHONE BOX
- EXISTING COLUMN
- EXISTING OVERHEAD ELECTRIC LINE
- EXISTING WATER LINE
- EXISTING CHAIN LINK FENCE
- EXISTING UNDERGROUND ELECTRIC LINE
- EXISTING TELEPHONE LINE
- EXISTING STORM DRAIN
- EXISTING GAS LINE
- EXISTING CONTOUR LINE
- EXISTING HYDRONIC PIPES

ALAMO COLLEGES
2221 N. Alamo St.
San Antonio, TX 78213

PREPARED BY:
BAIN MEDINA BAIN, INC.
ENGINEERS & SURVEYORS
7079 San Pedro Avenue
San Antonio, Texas 78216
210/494-7529
TBEPL Registration No. F-1712
TBEPLS Registration No. 10020900

ALAMO COLLEGES
PALO ALTO COLLEGE
STUDENT CENTER
EXTERIOR & UNDERFLOOR IMPROVEMENTS
SAN ANTONIO, TEXAS
PROJECT NUMBER: C-1480.46

REVISIONS:	
SHEET TITLE OVERALL GRADING PLAN	
DATE 04/12/24	DRAWN BY RG
PROJECT NUMBER C-1480.46	SHEET NUMBER C-4.0



Date: Apr 11, 2024, 4:30pm, User: R. Rincon
 File: W:\Texas\C-1480.46\FAC Student Center Drainage Improv Bldg 6 - ACCO Design Civil Construction Documents\C-1480.46 EXT GRADING PLAN OVERALL.dwg

Estimated Time-frame: October 8th, 2024 to January 9th, 2025

 TEMP. CONSTRUCTION FENCE

 PHASE 2

- Demolition of Flatwork at South Side
- Installation of Storm Drain at South Side
- Installation of Flatwork at North, East and South

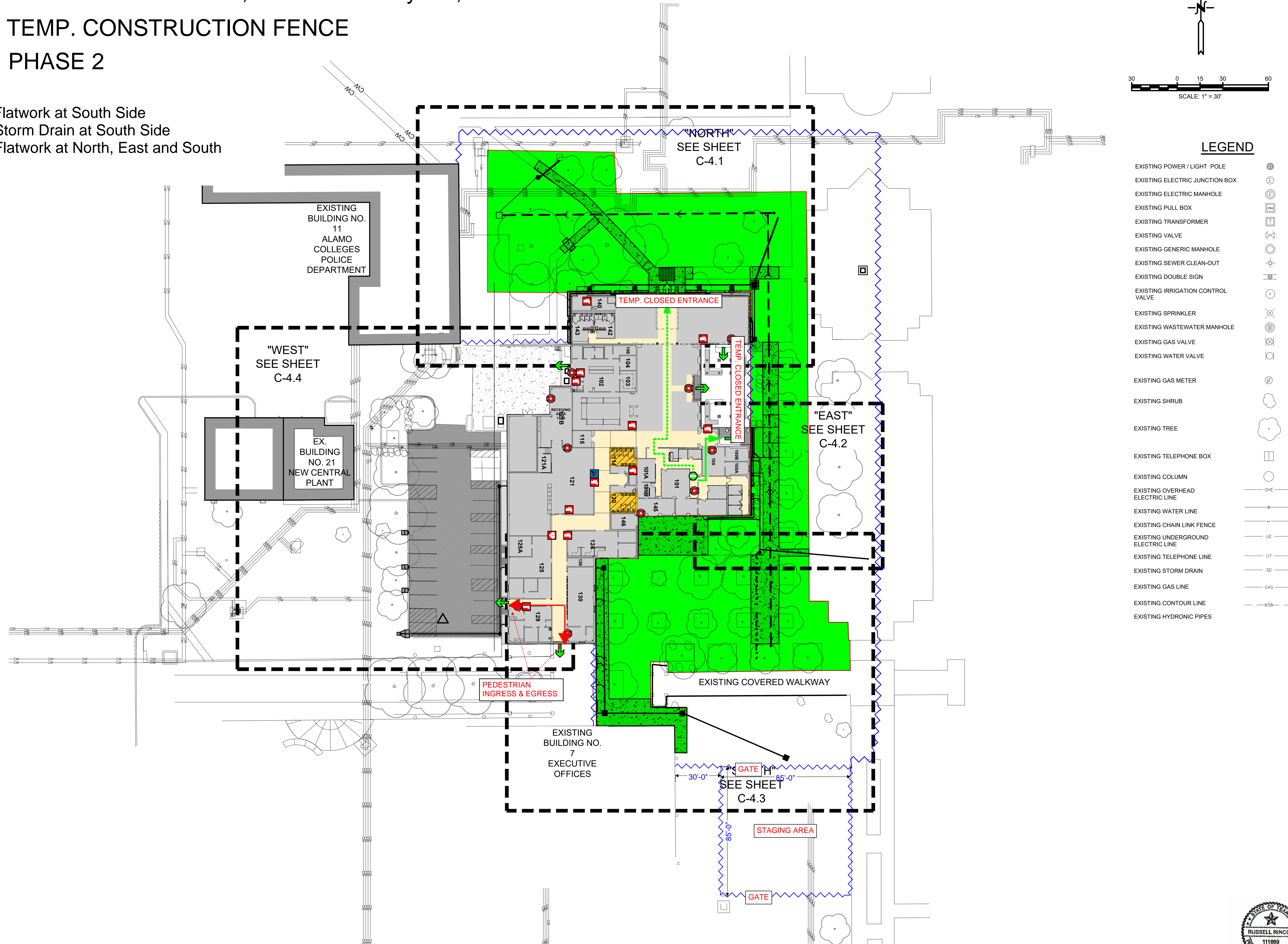

LEGEND

- EXISTING POWER / LIGHT POLE
- EXISTING ELECTRIC JUNCTION BOX
- EXISTING ELECTRIC MANHOLE
- EXISTING PULL BOX
- EXISTING TRANSFORMER
- EXISTING VALVE
- EXISTING GENERIC MANHOLE
- EXISTING SEWER CLEAN-OUT
- EXISTING DOUBLE SIGN
- EXISTING IRRIGATION CONTROL VALVE
- EXISTING SPRINKLER
- EXISTING WASTEWATER MANHOLE
- EXISTING GAS VALVE
- EXISTING WATER VALVE
- EXISTING GAS METER
- EXISTING SHRUB
- EXISTING TREE
- EXISTING TELEPHONE BOX
- EXISTING COLUMN
- EXISTING OVERHEAD ELECTRIC LINE
- EXISTING WATER LINE
- EXISTING CHAIN LINK FENCE
- EXISTING UNDERGROUND ELECTRIC LINE
- EXISTING TELEPHONE LINE
- EXISTING STORM DRAIN
- EXISTING GAS LINE
- EXISTING CONTOUR LINE
- EXISTING HYDRONIC PIPES

ALAMO COLLEGES
2221 N. Alamo St.
San Antonio, TX 78213



PREPARED BY:
BAIN MEDINA BAIN, INC.
ENGINEERS & SURVEYORS
7079 San Pedro Avenue
San Antonio, Texas 78216
210/494-7229
TBEPL Registration No. F-1712
TBEPLS Registration No. 10020900



ALAMO COLLEGES
PALO ALTO COLLEGE
STUDENT CENTER
EXTERIOR & UNDERFLOOR IMPROVEMENTS
SAN ANTONIO, TEXAS
PROJECT NUMBER: C-1480.46

REVISIONS:	
SHEET TITLE	
OVERALL GRADING PLAN	
DATE	04/12/24
PROJECT NUMBER	C-1480.46
DRAWN BY	RG
SHEET NUMBER	



RJR
04/12/2023

C-4.0

Date: Apr 11, 2024, 10:29am, User: RG, Project: 1480.46, File: W:\1480.46\FAC_SitePlan_Center_Drainage_Improvements_Bldg_6 - ACCO Design Civil Construction Documents\C-1480.46 EXT GRADING PLAN OVERALL.dwg

Estimated Time-frame: January 10th to January 29th, 2025

 TEMP. CONSTRUCTION FENCE

 PHASE 3

- Demolition of Flatwork and Curb
- Installation of Storm Drain at West Side
- Installation of Flatwork

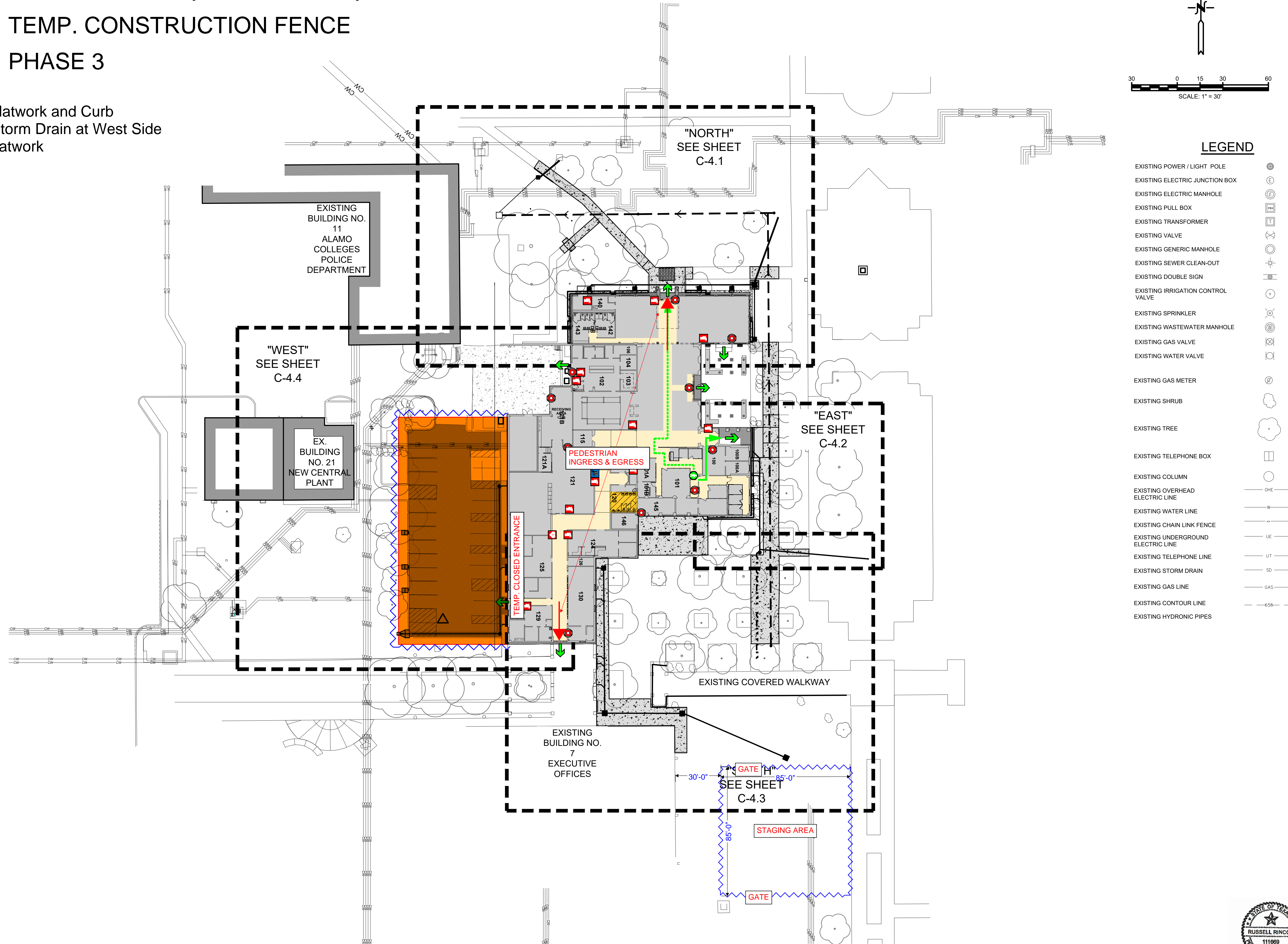

LEGEND

- EXISTING POWER / LIGHT POLE
- EXISTING ELECTRIC JUNCTION BOX
- EXISTING ELECTRIC MANHOLE
- EXISTING PULL BOX
- EXISTING TRANSFORMER
- EXISTING VALVE
- EXISTING GENERIC MANHOLE
- EXISTING SEWER CLEAN-OUT
- EXISTING DOUBLE SIGN
- EXISTING IRRIGATION CONTROL VALVE
- EXISTING SPRINKLER
- EXISTING WASTEWATER MANHOLE
- EXISTING GAS VALVE
- EXISTING WATER VALVE
- EXISTING GAS METER
- EXISTING SHRUB
- EXISTING TREE
- EXISTING TELEPHONE BOX
- EXISTING COLUMN
- EXISTING OVERHEAD ELECTRIC LINE
- EXISTING WATER LINE
- EXISTING CHAIN LINK FENCE
- EXISTING UNDERGROUND ELECTRIC LINE
- EXISTING TELEPHONE LINE
- EXISTING STORM DRAIN
- EXISTING GAS LINE
- EXISTING CONTOUR LINE
- EXISTING HYDRONIC PIPES

REVISIONS:	
SHEET TITLE	
OVERALL GRADING PLAN	
DATE	04/12/24
PROJECT NUMBER	C-1480.46
DRAWN BY	RG
SHEET NUMBER	



RJR
 04/12/2023

C-4.0

Date: Apr 11, 2024, 10:29:11 AM, User: RG, Project: 24-0001, File: \\fs1\work\C-1480.46\FAC_Siteplan_Center_Drainage_Improvements_Bldg_6 - ACCO Design Civil Construction Documents\C-1480.46 EXT GRADING PLAN OVERALL.dwg